

2013
Valley of Fire
Stage Race



USA Cycling
Permit Pending
Updated 11/12/2012

Event Sponsors

Table of Contents

- 1. Introduction and Welcome letter**
- 2. Sponsors Page**
- 3. Event Staff List and Categories**
- 4. Overall Stage Race Information**
- 5. Stage 1: Time Trial**
- 6. Stage 2: Criterium**
- 7. Stage 3: Valley of Fire Road Race**
- 8. Scoring**
- 9. Prize List**
- 10. Time Trial Map**
- 11. Criterium Map**
- 12. Road Race Map**

Introduction and Welcome letter

Dear Race Participant,

We want to thank you for participating in the first Valley of Fire Stage Race. We are excited to bring you a great 3 stage 2 day event. Never before has a race explore the terrain that you will race this weekend.

With the support of sponsors and local city officials we continue to fine tune and put together a quality event that gives back to the communities and cycling. We hope that race attracts many spectators, especially at the Moapa Valley High School criterium. We would like to leave a **LASTING POSITIVE** impression on everyone attending this event. **Please be on your best behavior since you are representing our event, your team and cycling in general.**

In addition to the USA Cycling Rulebook (www.usacycling.org/forms/USAC_rulebook.pdf) you are responsible for reading and following the rules set forth in this race bible.

The following items are of particular importance:

Parking: Park only where indicated

Portable Toilets: Nothing will get us kicked out of a venue faster than using private property as a toilet.

Helmets: Must be worn and secured at all times while on a bicycle. From check in to final awards

Road Race Traffic: The centerline rule is in effect unless otherwise instructed by a race official.

FAILURE TO COMPLY WITH THESE REQUESTS WILL RESULT IN FINES &/OR DISQUALIFICATION

That being said, welcome to our race and I wish you the best of luck!

Sincerely,
RaceDay Event Management & Services LLC

Event Staff List

Event Director: Dirk Cowley
Operations Director: Mike ?
Registration Director: Brittany Jones
Chief Official: Chris Black
Chief Judge: Holly Blanco and Trish Black
Officials: ?
 ?
 ?
Medical Support:
Police Support:

Event Categories

Male Categories

Cat 1-2-3

Cat 3-4

Cat 5

Master 35+ Cat 1-2-3-4

Master 45+ Cat 1-2-3-4 (Special award to top 3 55+ and 60+ riders)

Female Categories

Open Women (Special award to the top 3 cat 4 riders)

Overall Stage Race Information

GENERAL INFORMATION AND SCORING POLICIES

This is a 2-day 3-stage event timed stage race based on cumulative time. The winner from each category will have the lowest elapsed time over the course of the 2-day race.

REGISTRATION

PRE-REGISTRATION ONLY. Online registration is at www.BikeReg.com we have a limit of 75riders per category. Cat 1-2-3 men limited to 100

NO REFUNDS ALLOWED ONCE REGISTRATION CLOSES

NO rider substitutions or replacements are allowed

Riders must register for the category listed on their USA Cycling license.

Riders will not be allowed to change their category at the race

Riders must have a current USA Cycling license.

ONLY Sr Men Cat 5 & Sr Women Cat 4 are eligible for one-day licenses

SIGN-IN

Riders are REQUIRED to sign-in before the Criterium and Road Race (There is no sign-in required for the TT). Failure to sign-in will result in a fine of \$20.00 for the first offense, per USAC rules. Check individual stage details for sign-in locations and additional instructions.

SCORING

Riders **MUST** complete each stage in order to start the next.

TIME BONUSES

Criterium: Will have time bonuses of 10, 6 and 4 seconds for 1ST, 2ND, and 3 finishers.

Road Race Finish: Will have time bonuses of 10, 6 and 4 seconds for 1ST, 2ND and 3rd finishers.

Road Race KING OF THE MOUNTAIN and QUEEN OF THE MOUNTAIN On top of the climb a time bouns of 5, 3 and 1 seconds for 1st, 2nd and 3rd respectively

RESULTS

Will be posted nightly at the following locations:

TBD

FINAL RESULTS will be posted online at WWW.RaceDayEventManager.com and reported to USA Cycling

(www.usacycling.org) **THESE RESULTS ARE FINAL**

PROTESTS

DO NOT LEAVE UNTIL YOU HAVE REVIEWED THE FINAL POSTED RESULTS!

Time Trial: Protests for the TT must be made to the Chief Judge within 15 minutes of posting.
Criterium: Protests for the CRIT must be made to the Chief Judge within 15 minutes of posting.
Road Race: Protests for the RR must be made to the Chief within 15 minutes of posting.

CENTERLINE

All roads are open to traffic. Obey and respect all police officer, official, and staff requests. **If you cross the centerline you will be disqualified!** If no painted centerline marking exists, riders must keep to the right side of the road **at all times unless instructed by an official.**

RACE NUMBERS

Each rider will be given two (2) bib numbers and one (1) frame number.
DO NOT CUT, FOLD, WRINKLE or ALTER NUMBERS!

Jersey Numbers

Only One Bib number is required for the Time Trial Right Side placement
All riders **MUST WEAR BOTH** bib numbers Criterium and Road Race. If you do not wear both bib numbers you will be assessed a **20-second penalty!** Numbers must be worn on the lower part of the jersey just above the jersey pocket and along the side seam

Frame Numbers

Time Trial: Frame number is **NOT** required
Criterium and Road Race: Frame number **IS** required

Stage 1: Hidden Valley Time Trial

P/B Sponsor Insert

Saturday , 23 February 2013 8:00 AM first rider off

LOCATION: Intersection of I-15 and Hidden Valley Dr (St 78)

PARKING: As directed by event staff and signs.

COURSE DESCRIPTION: This will be a challenging out and back course on good pavement. This course will not favor any style of rider but will go to a great overall rider.

WARM UP

Please bring trainers to warm up on. Limited roads are open to warm up.

NEUTRAL WHEEL SUPPORT None Provide

.

MECHANICALS/FLAT TIRES

If you have a flat in the TT you can either fix the flat yourself OR you can wait for the sweep vehicle to pick you up. Do not ruin a wheel or endanger yourself or others by riding a flat. You will be given a slower time for the day and will be allowed to start the road race, if reported to and verified by an official.

START ORDER

Start times will be determined by registration date and time first rider registered last rider of in that category

Cat 5 Men

45+ Men

35+ Men

Cat 3-4 Men

Open Women

Cat 1-2-3 Men

TIME TRIAL RESULTS

Results will be posted thru out the event on the result board at the start area. Protests must be made as per USAC Rules. General Classification results will not be posted after the Time Trial.

Stage 2: Moapa High School Criterium

P/B Sponsor Insert

Saturday , 23 February 2013

LOCATION: Moapa Valley High School Paul and Airport Road

PARKING: TBD

Map and Elevation guide attached at back of the Tech Guide

COURSE DESCRIPTION: Located at the Moapa Valley School this four corner Criterium will test the riders in the true US criterium style, four corners fast and flat.

Map and Elevation guide attached at back of the Tech Guide

WARM UP

Please bring trainers to warm up on. Limited roads are open to warm up.

NEUTRAL WHEEL SUPPORT

Neutral wheels are provided in a limed number. Please provide wheels to the pit prior to your race. Mark wheels with Name and Bib number.

.

MECHANICALS/FLAT TIRES

If you have a flat tire or a mechanical/crash in the Criterium you must report to the wheel pit as required by the Chief Official. Free laps will be determined by Chief Official and announced at the start of the race.

EVENT START ORDER, DURATION, AND TIME

Cat 5 Men	30 Min	1:00 PM
45+ Men	45 Min	1:35 PM
35+ Men	45 Min	2:10 Pm
Cat 3-4	45 Min	3:00 PM
Open Women	45 Min	4:00 PM
Cat 1-2-3 Men	45 Min	5:00 PM

CRITERIUM RESULTS: Results will be posted thru out the event on the result board at the check in area. Protests must be made as per USAC Rules. General Classification results will be posted as soon as event protest period has pasted.

Stage 3: Valley of Fire Road Race

P/B Sponsor Insert

Sunday , 24 February 2013

LOCATION: Overton, NV

PARKING: TBD

COURSE DESCRIPTION

This is an out and back course that rolls thru the Valley of Fire State Park. One of the most scenic and challenging course that we could find. Map and Elevation guide attached at back of the Tech Guide

WARM UP:

Please bring trainers to warm up on. Limited roads are open to warm up.

AREAS OF CONCERN:

This is a list of areas that pose a potential hazard to riders.

PLEASE NOTE

Park Entrance at the base of the climb and during the descent back to the finish. Please slow down and follow the course marking.

The turnaround at the half way point, this is fast and the race is not won here.

NEUTRAL WHEEL SUPPORT

Follow cars are provide and are wheels In Wheels out unless they are declared neutral by the chief official. All wheel changes must be done from the right side f the road.

EVENT START ORDER, DURATION, AND TIME

Cat 1-2-3 Men	72 miles	8:00 AM	
35+ Men	72 miles	8:10 AM	
45+ Men	72 Miles	8:15 AM	
Cat 3-4 Men	72 miles	8:20 AM	
Open Women	72 miles	8:25 AM	
Cat 5 Men	45 miles	8:30 AM	Special Course

ROAD RACE RESULTS

Results will be posted thru out the event on the result board at the check in area. Protests must be made as per USAC Rules. General Classification results will be posted as soon as event protest period has pasted.

AWARDS

The awards ceremony will be held as soon as the results are finial. Riders are required to be present at the awards to receive the prizes. No prizes will be mailed post event.

Prize List

The awards ceremony will be held as soon as the results are final. Riders are required to be present at the awards to receive the prizes. No prizes will be mailed post event.

Promoter reserves the right to change the prize purse and to combine categories.

Stage Prizes

Category	TT	Crit	Road Race
Cat 1-2-3 Men	\$25	\$15	\$10
Cat 3-4 Men	\$15	\$10	\$5
Cat 5 Men	Prizes	Prizes	Prizes
Master 35+	\$15	\$10	\$5
Master 45+	\$15	\$10	\$5
Open Women	\$15	\$10	\$5

Overall Prizes

Category	1st	2nd	3rd	4th	5th	6th	7th	8th	9th	10th
Cat 1-2-3 Men	\$125	\$100	\$85	\$75	\$65	\$50	\$30	\$30	\$30	\$30
Cat 3-4 Men	\$75	\$65	\$55	\$45	\$30	\$30	\$30	\$30	\$30	\$
Cat 5 Men	Prizes	Prizes	Prizes	Prizes	Prizes					
Master 35+	\$100	\$80	\$60	\$40	\$30	\$30	\$30	\$30	\$30	\$
Master 45+	\$100	\$80	\$60	\$40	\$30	\$30	\$30	\$30	\$30	\$
Open Women	\$100	\$80	\$60	\$40	\$30	\$30	\$30	\$30	\$30	\$30

- Overall prize list may be adjusted based on ridership with the approval of the Chief Official

Time Trial Map

Hidden Valley TT

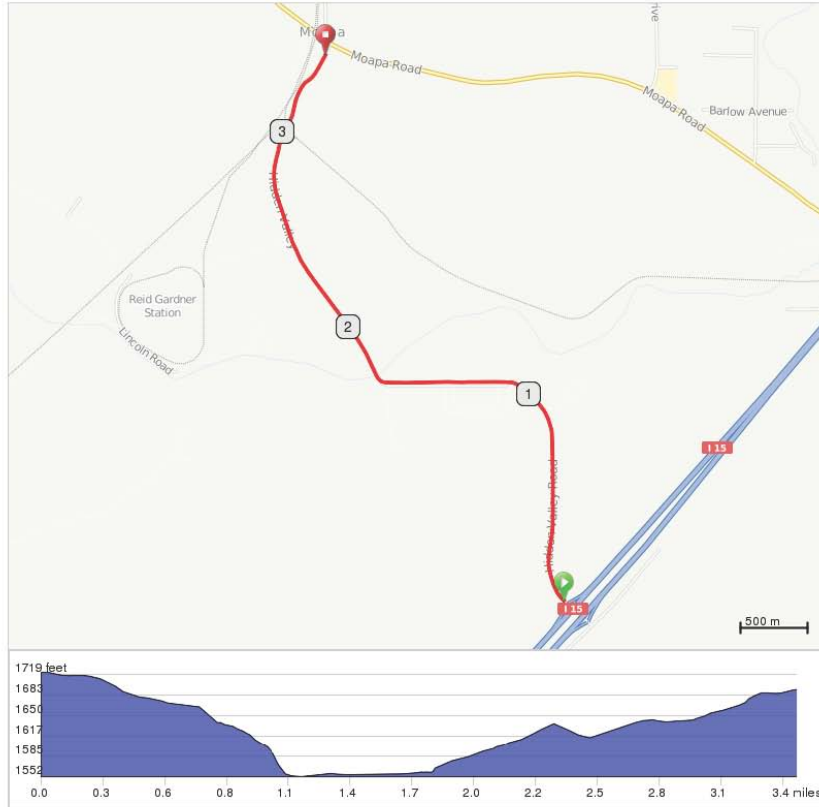

Distance: 3.4 mi
Elevation: +172 / -200 ft
Pavement: normal pavement
Good For: cycling

Notes: This is an out and back time trial.

Criterion Map

Valley of Fire Criterion

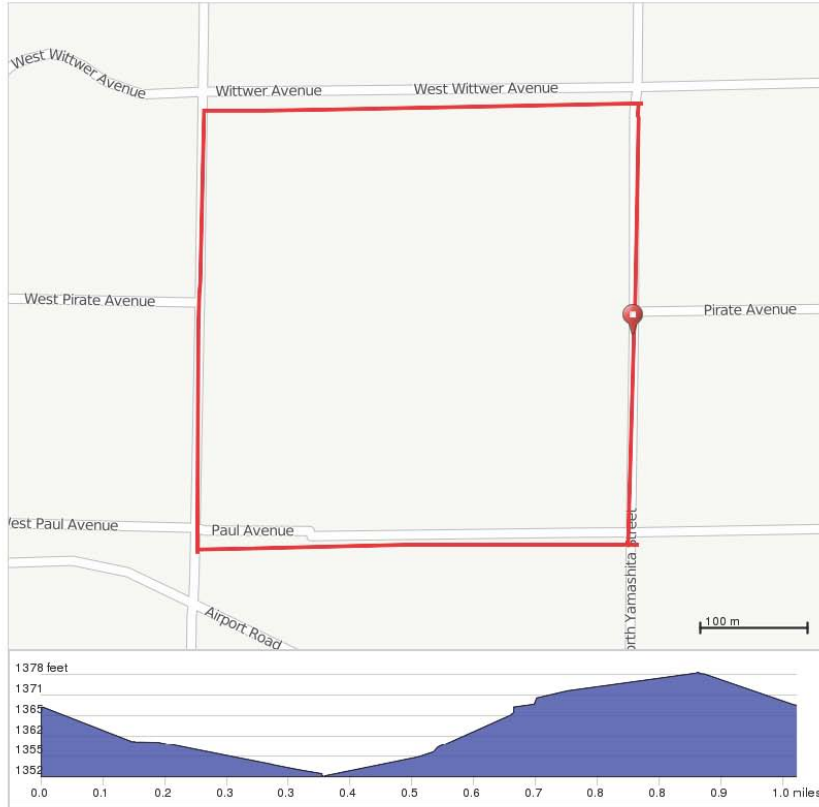

Distance: 1.0 mi
Elevation: + 27 / - 26 ft
Pavement: beautiful pavement
Good For: cycling

Notes: This is a fast four corner Criterion. There is minimal elevation gain

Road Race Map

Valley of Fire Road Race

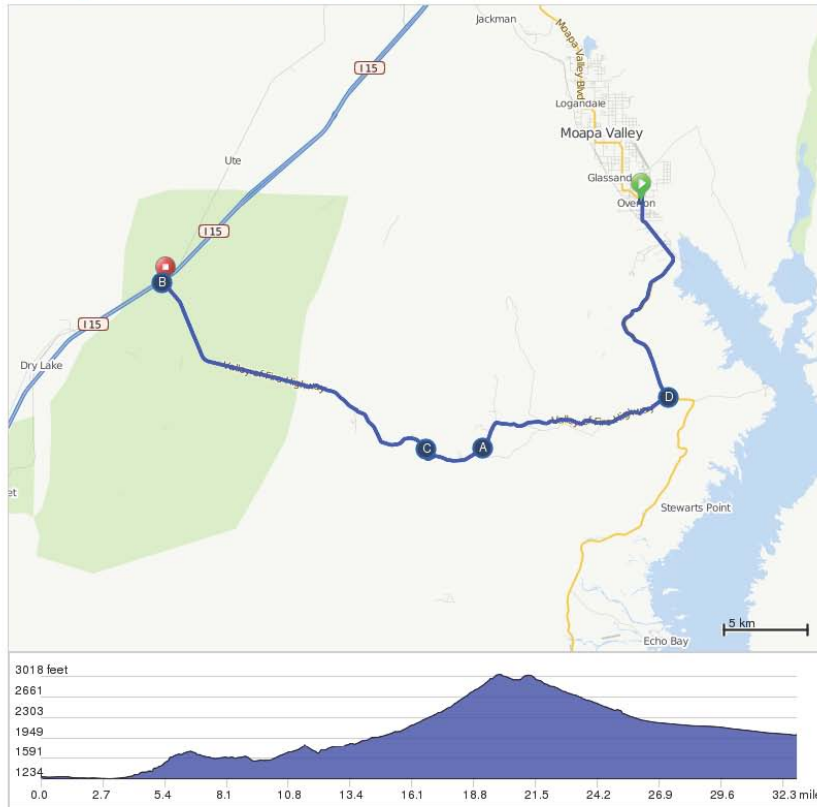

Notes: This is an out and back course. Control at the park entrance coming back, riders will be directed to the far right of the booth. Failure to slow and follow direction may result in disqualification. Cat 5 riders will turn at the guard shack under directions of Park Rangers.

Road Race Map Cat 5 Men

Valley of Fire cat 5 course

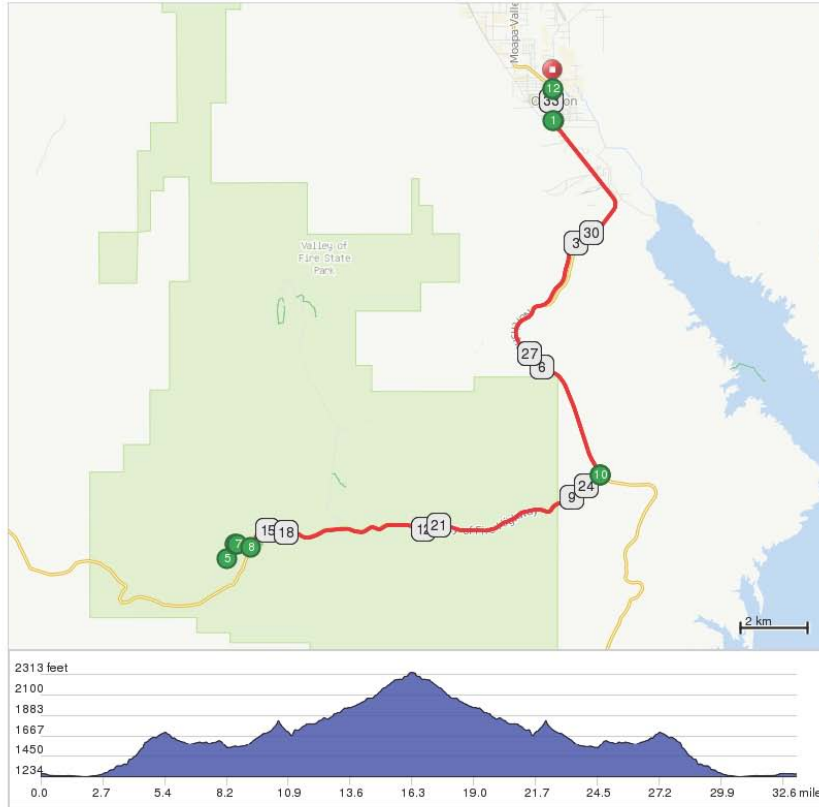

Distance: 33.2 mi
Elevation: + 2037 / - 2043 ft
Pavement: normal pavement
Good For: cycling

Notes: Turnaround is at the camp ground loop. Please use caution and keep an eye out for campers.